

## Carpark and Walkway—Petersen Road, Craignish

### PROJECT:

This project provides for the construction of a new asphalt carpark in Petersen Road, Craignish between the existing effluent disposal area and the basketball court. A new concrete walkway will also be included as part of the works.

The carpark and walkway upgrades are being undertaken to provide a safe means to access the park and are in accordance with the adopted enhancement plan for this park. The works were identified for completion following increased usage of this park area.

### PROJECT ESTIMATE:

\$145,000

### PROJECT SCOPE OF WORKS

The Project scope is as follows:

- Earthworks;
- Installation of new pavement material;
- Kerb installation works;
- Stormwater and subsoil drainage works;
- Bitumen/asphalt surfacing;
- Construction of new concrete walkway;
- Pavement marking;
- Reinstatement works.



The traffic management plan that will be put in place for the duration of the construction period will be developed prior to works commencing.

### INDICATIVE PROJECT MILESTONES

|              |                     |
|--------------|---------------------|
| Sept 2020    | Final Design        |
| Oct 2020     | Tender Period       |
| Dec/Jan 2021 | Construction Period |
| Feb 2021     | Project Completion  |

Note: Project milestones are subject to contract and weather and may change.

# Carpark and Walkway—Petersen Road, Craignish

| LEGEND - EXISTING |                                       |
|-------------------|---------------------------------------|
|                   | EXISTING PAVEMENT SURFACING           |
|                   | EXISTING LOT BOUNDARY                 |
|                   | EXISTING ROAD CENTRELINE              |
|                   | EXISTING KERB INVERT                  |
|                   | EXISTING LIP OF KERB                  |
|                   | EXISTING BACK OF KERB                 |
|                   | EXISTING UNDERGROUND ELECTRICITY LINE |
|                   | EXISTING WATERMAIN                    |
| LEGEND - PROPOSED |                                       |
|                   | PROPOSED BOTTOM OF BATTER             |
|                   | PROPOSED TOP OF BATTER                |
|                   | PROPOSED PAVEMENT SURFACING           |
|                   | PROPOSED CONCRETE                     |
|                   | PROPOSED BATTER - 1 IN 6              |
|                   | PROPOSED BATTER - 1 IN 4              |
|                   | PROPOSED EDGE OF BITUMEN              |
|                   | PROPOSED DESIGN LEVEL                 |

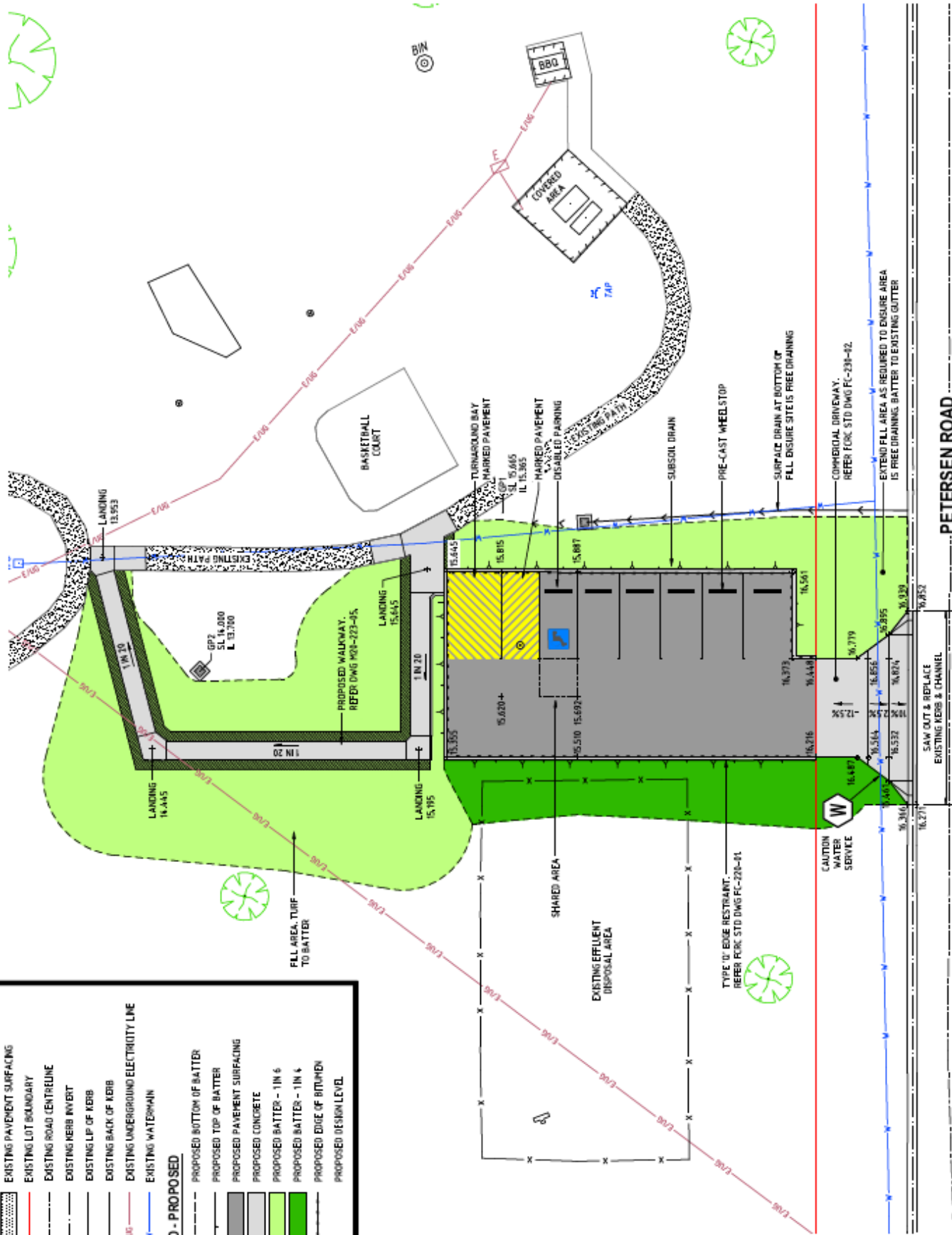

PETERSEN ROAD