



Pavement Rehabilitation Works—Lennox Street (Railway Line to Walker Street)

PROJECT:

This project provides for pavement rehabilitation works in Lennox Street from the railway line near Woolworths to Walker Street.

PROJECT ESTIMATE:

\$800,000 (this project is funded through the State Government’s Works for Queensland Funding Program)

PROJECT SCOPE OF WORKS

The Project scope is as follows:

- Asphalt pavement re-surfacing works in Lennox Street from the Railway line to Sussex Street (milling of existing road pavement will be undertaken prior to resurfacing works);
- Bitumen pavement sealing works in Lennox Street from Sussex Street to Walker Street (road box reconstruction works will be undertaken prior to sealing works);
- New kerb and channel in various sections including area in front of fig trees, Queens Park and a section in front of 232-238 Lennox Street;
- New driveway crossovers at 232, 236 and 238 Lennox Street, Maryborough;
- New kerb ramps at the corner of Lennox and Sussex Streets and Lennox and Walker Street;
- Topdressing and turfing of disturbed areas.



The traffic management plan that will be put in place for the duration of the construction period will be developed prior to works commencing.

INDICATIVE PROJECT MILESTONES

Sept 2020	Final Design
Oct /Nov 2020	Tender Period
Dec/Feb 2021	Construction Period
March 2021	Project Completion

Note: Project milestones are subject to contract and weather and may change.

Pavement Rehabilitation Works—Lennox Street (Railway Line to Walker Street)

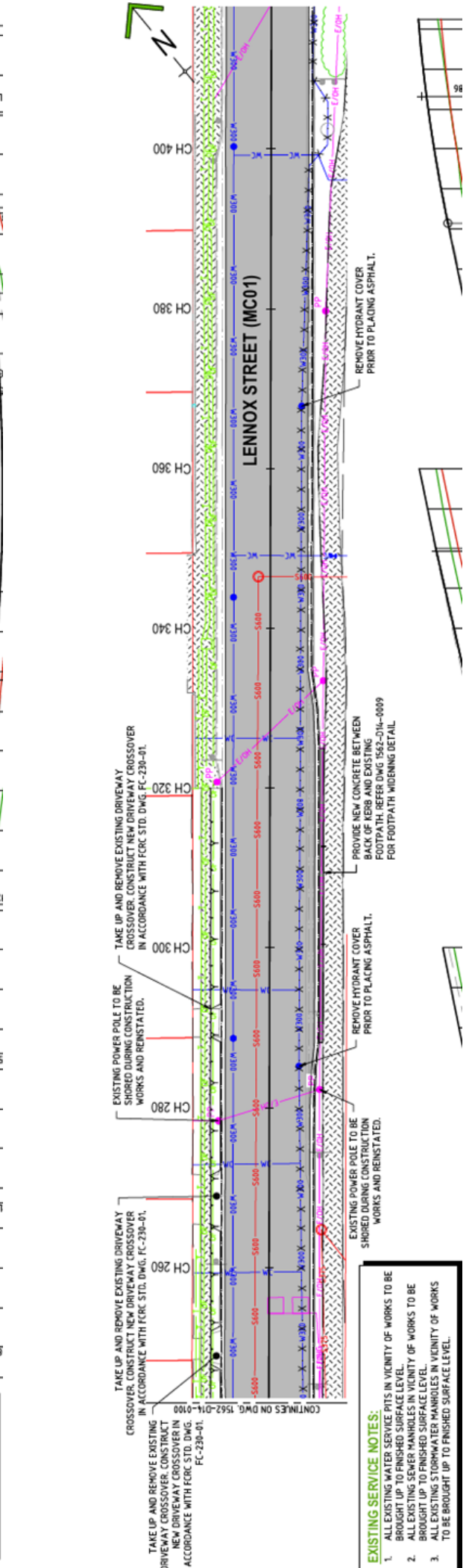
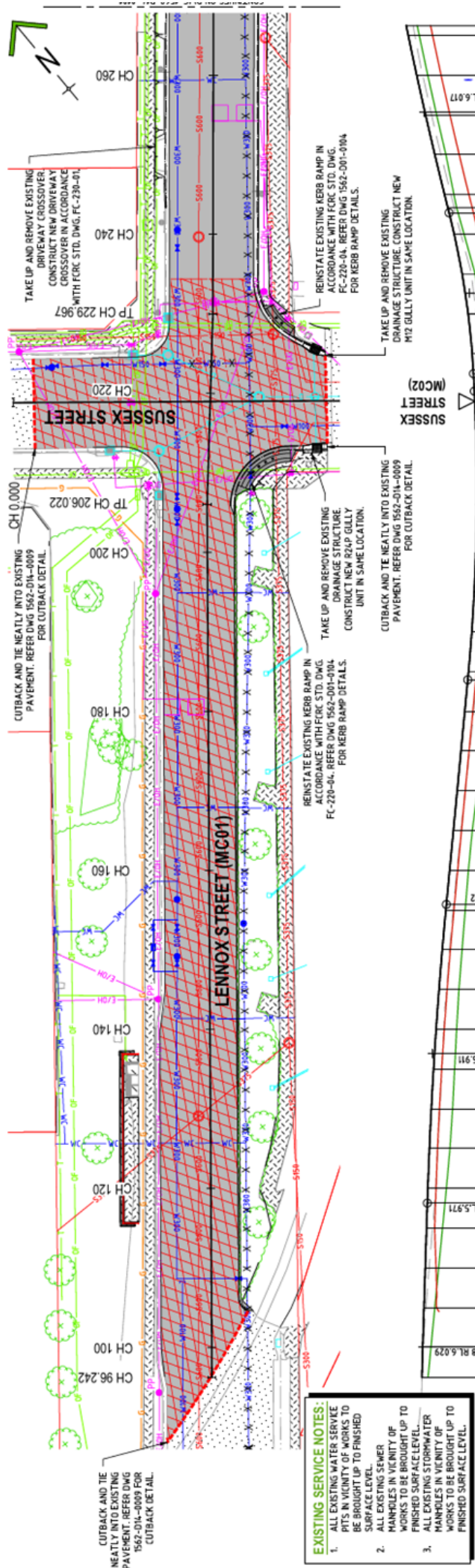

Pavement Rehabilitation Works—Lennox Street (Railway Line to Walker Street)

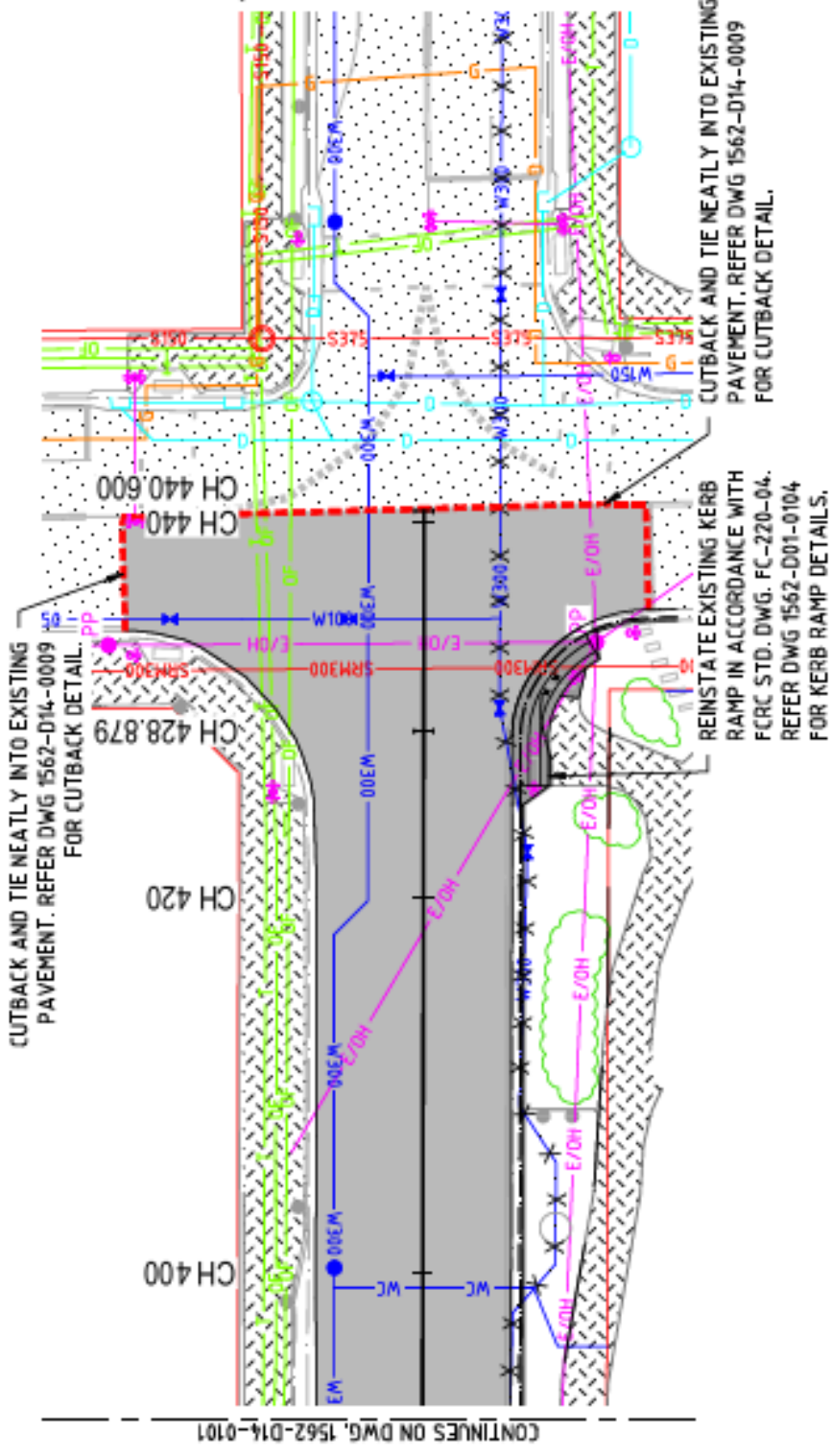

LEGEND

EXISTING TRAFFIC SIGNAL	PP
EXISTING POWERPOLE	E/OH
EXISTING OVER HEAD ELECTRICITY LINE	E/UG
EXISTING UNDERGROUND ELECTRICITY LINE	G
EXISTING GAS LINE	OF
EXISTING OPTIC FIBRE LINE	T
EXISTING TELECOMMUNICATIONS LINE	S
EXISTING TELSTRA OR OPTIC FIBRE STRUCTURE	S375
EXISTING 1500 GRAVITY SEWER MAIN	S660
EXISTING 3750 GRAVITY SEWER MAIN	W
EXISTING 6000 GRAVITY SEWER MAIN	W100
EXISTING WATERMAIN	W150
DECOMMISSIONED WATER MAIN	W200
EXISTING 1000 WATERMAIN	W225
EXISTING 1500 WATERMAIN	W300
EXISTING 2000 WATERMAIN	WC
EXISTING 2250 WATERMAIN	DEL
EXISTING 2500 WATERMAIN	OH
EXISTING 3000 WATERMAIN	SW
EXISTING WATER CONDUIT	D
EXISTING DEAD END CAP	
EXISTING FIRE HYDRANT	
EXISTING STOP/SLUICE VALVE	
EXISTING DRAINAGE LINE	
EXISTING LOT BOUNDARY	X
EXISTING FENCE	
EXISTING CONCRETE EDGE LINE	
EXISTING EDGE OF BITUMEN	
EXISTING KERB AND CHANNEL	
EXISTING PAVEMENT SURFACING	
EXISTING CONCRETE	
PROPOSED CUTBACK LINE	
PROPOSED KERB AND CHANNEL	
PROPOSED BOTTOM OF BATTER	
PROPOSED TOP OF BATTER	
PROPOSED PAVEMENT SURFACING	
PROPOSED AREA OF MILLING	
PROPOSED CONCRETE	