

Kerb and Channel Replacement — Scott Street (March Street to Zante Street)

PROJECT:

This project provides for the replacement of the existing kerb and channel and pavement reinstatement works on both sides of Scott Street between March Street and Zante Street. Works also include the installation of new stormwater drainage pipes, subsoil drainage works and driveway extensions to suit the new kerb alignment.

The works are being undertaken as a result of inspections carried out as part of Council’s ongoing asset inspection program which identified that the kerb and channel was showing signs of failure and distress.

PROJECT ESTIMATE:

\$320,000

PROJECT SCOPE OF WORKS:

- Removal and disposal of the existing kerb and channel;
- Earthworks and stormwater pit replacements with associated drainage works;
- Construction of new kerb and channel and pavement reinstatement;
- Reinstatement of driveway crossovers and kerb ramps;
- Reinstatement of disturbed verges.



The traffic management plan that will be put in place for the duration of the construction period plans for a full road closure with local traffic only allowed.

INDICATIVE PROJECT MILESTONES

Sept 2020	Final Design
March/June 2021	Construction Period
July 2021	Project Completion

Note: Project milestones are subject to weather and may change.

Kerb and Channel Replacement — Scott Street (March Street to Zante Street)

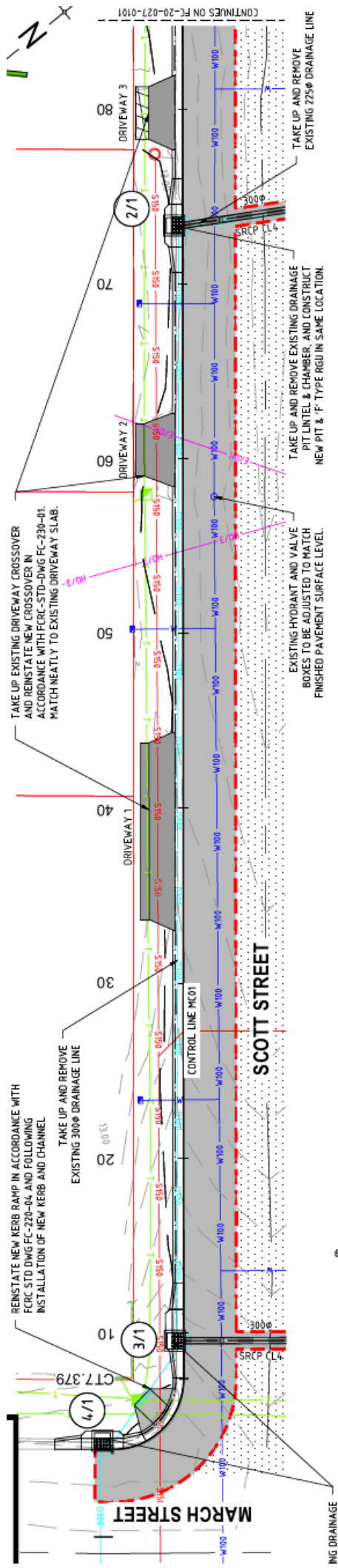

9

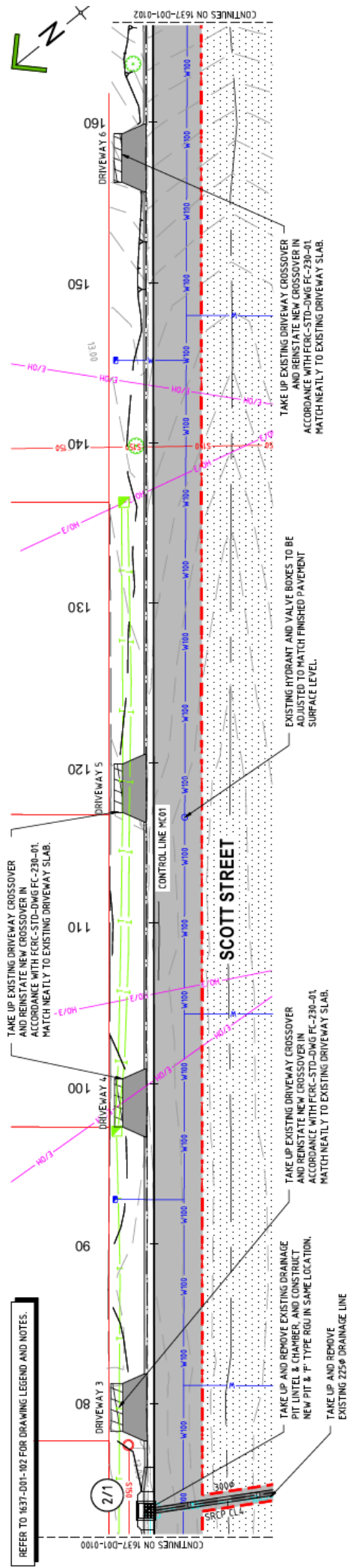

Kerb and Channel Replacement — Scott Street (March Street to Zante Street)

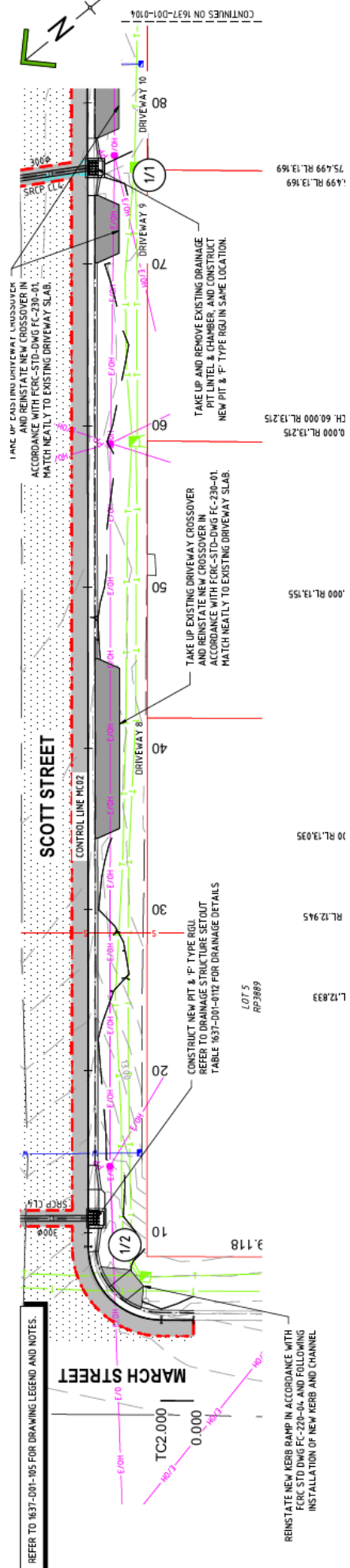
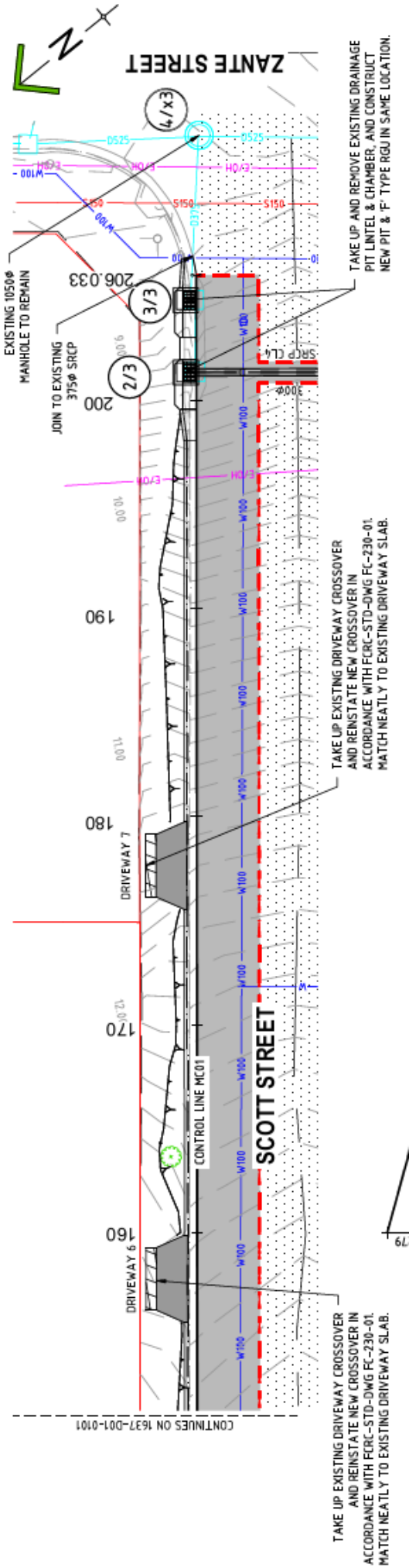

REFER TO 1637-001-005 FOR DRAWING LEGEND AND NOTES.

75.499 RL.13.169

1.499 RL.13.169

0.000 RL.13.215

CH. 60.000 RL.13.215

1.000 RL.13.155

10 RL.13.035

RL.12.945

L.12.833

3.118

TC2.000

0.000

1/2

1/1

80

70

60

50

40

30

20

10

Kerb and Channel Replacement — Scott Street (March Street to Zante Street)

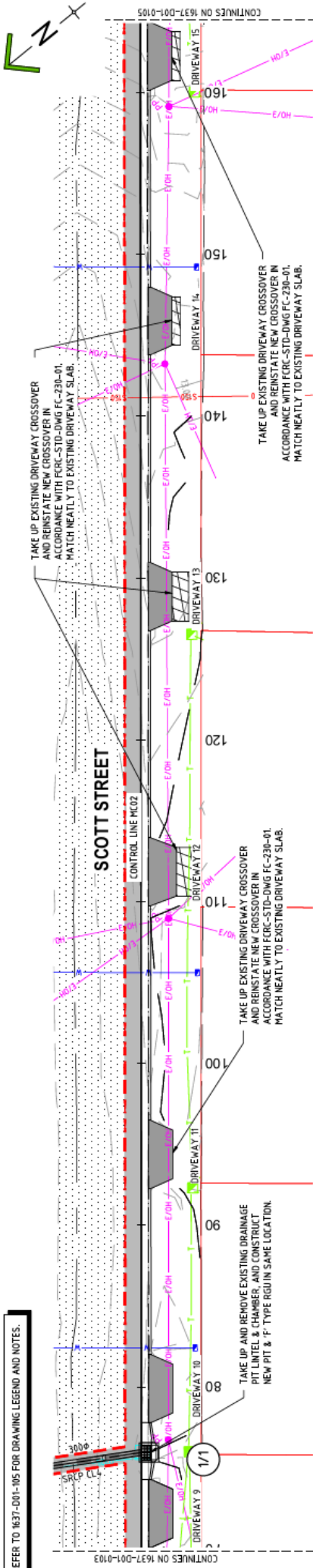

LEGEND

	EXISTING POWERPOLE
	EXISTING OVER HEAD ELECTRICITY LINE
	EXISTING 500 ϕ GRAVITY SEWER MAIN
	EXISTING 100 ϕ WATERMAIN
	EXISTING WATER CONDUIT
	EXISTING WATER METRE
	EXISTING FIRE HYDRANT
	EXISTING DRAINAGE CHAMBER
	EXISTING 450 ϕ DRAINAGE PIPE
	EXISTING 300 ϕ DRAINAGE PIPE
	EXISTING 525 ϕ DRAINAGE PIPE
	EXISTING TELSTRA LINE
	EXISTING TELSTRA OR OPTIC FIBRE STRUCTURE
	EXISTING FENCE
	EXISTING CONTOURS
	EXISTING LOT BOUNDARY
	EXISTING BOTTOM OF BATTER
	EXISTING TOP OF BATTER
	EXISTING KERB AND CHANNEL
	EXISTING ROAD CROWN
	EXISTING ROAD SIGNAGE
	EXISTING PAVEMENT SURFACING
	EXISTING CONCRETE
	EXISTING VEGETATION TO REMAIN
	PROPOSED DRAINAGE STRUCTURE
	PROPOSED TOP OF BATTER
	PROPOSED CUTBACK LINE
	PROPOSED SUBSOIL LINE
	PROPOSED KERB AND CHANNEL
	PROPOSED PAVEMENT SURFACING
	PROPOSED CONCRETE