

# Kerb and Channel Replacement—Panorama Drive (Bryant Street to Vista Street)

**PROJECT:**

This project provides for the replacement of the kerb and channel on both sides of Panorama Drive between Bryant Street and Vista Street.

The kerb and channel replacement works are being undertaken as a result of inspections carried out as part of Council’s ongoing asset inspection program which identified that the kerb and channel was showing signs of failure and distress.

**PROJECT ESTIMATE:**

\$707,000

**PROJECT SCOPE OF WORKS:**

The Project scope is as follows:

- Excavation and earthworks;
- Concrete kerb and channel works;
- Replacement of residential driveways (*reinstatement works to be completed in plain concrete only*);
- Subsoil drainage and new road gully units;
- Bitumen and asphalt resurfacing;
- Topdressing and turfing of disturbed areas



The traffic management plan that will be put in place for the duration of the construction period will be developed prior to works commencing.

INDICATIVE PROJECT MILESTONES	
Nov 2021	Final Design
Nov/Dec 2021	Tender Period
Feb/April 2022	Construction Period
May 2022	Project Completion

Note: Project milestones are subject to contract and weather and may change.

Kerb and Channel Replacement—Panorama Drive (Bryant Street to Vista Street)

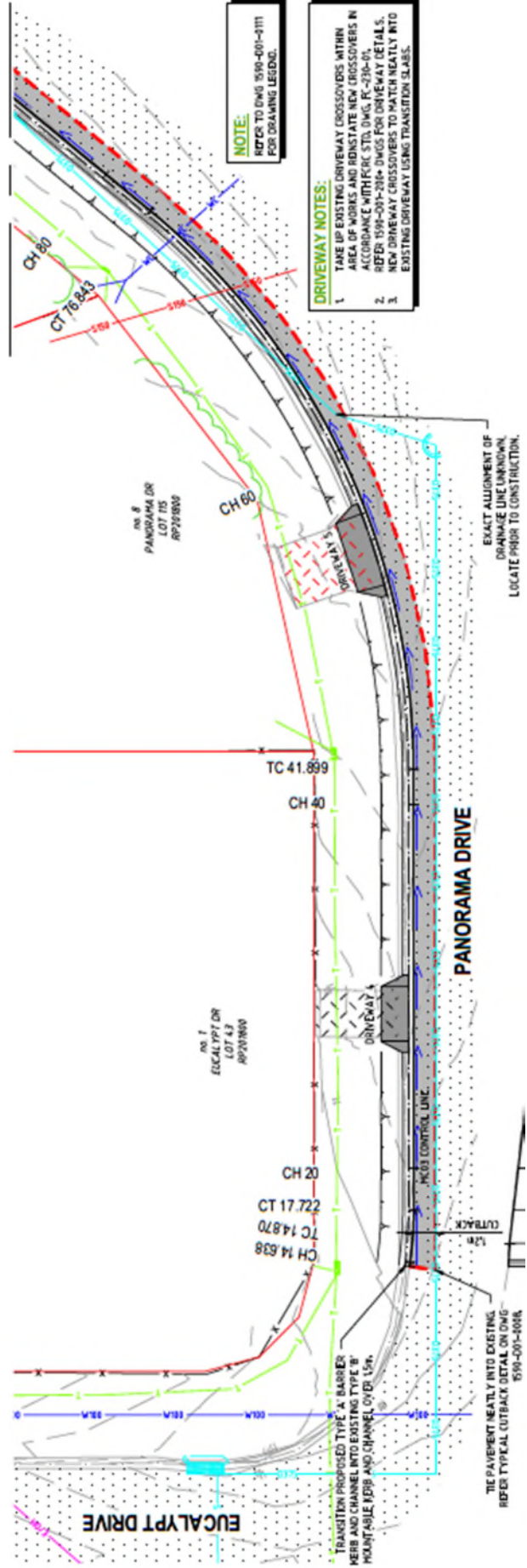
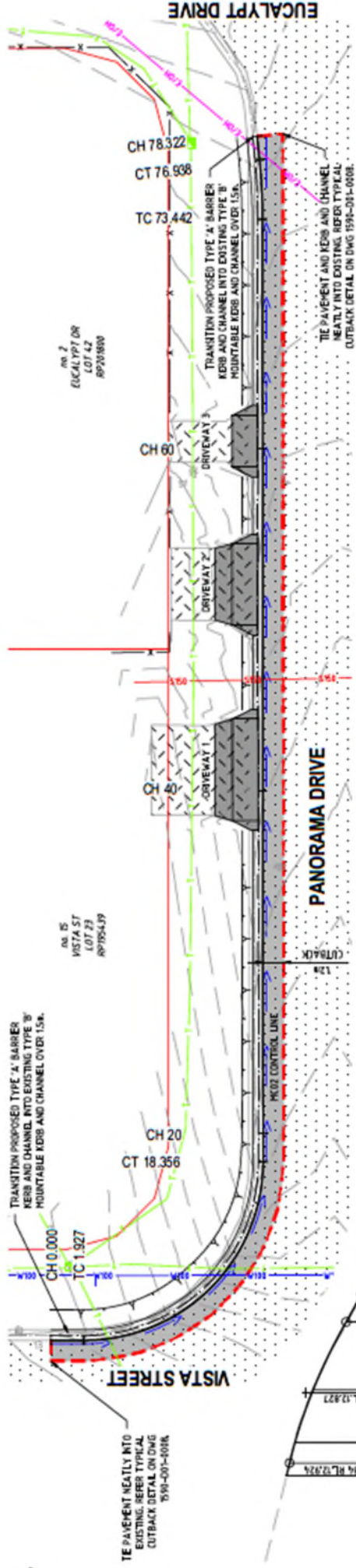



Kerb and Channel Replacement—Panorama Drive (Bryant Street to Vista Street)

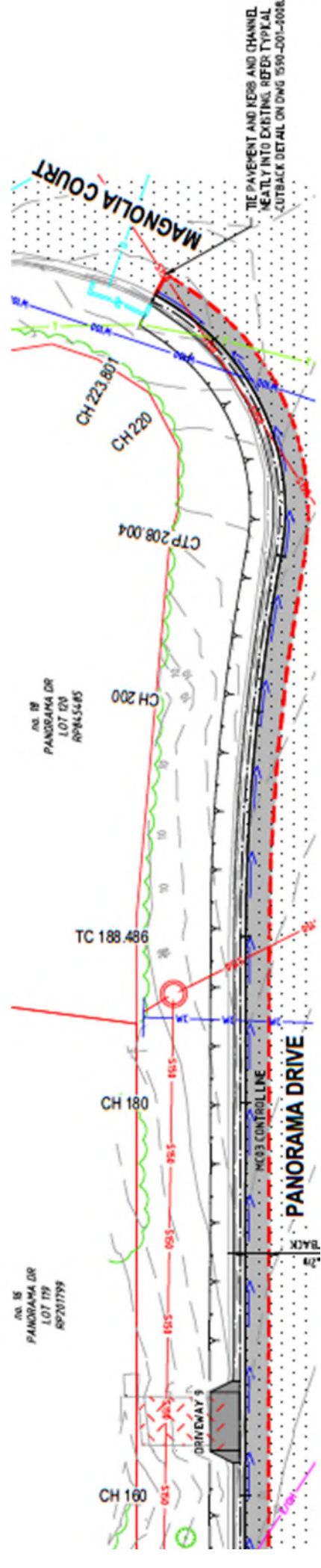
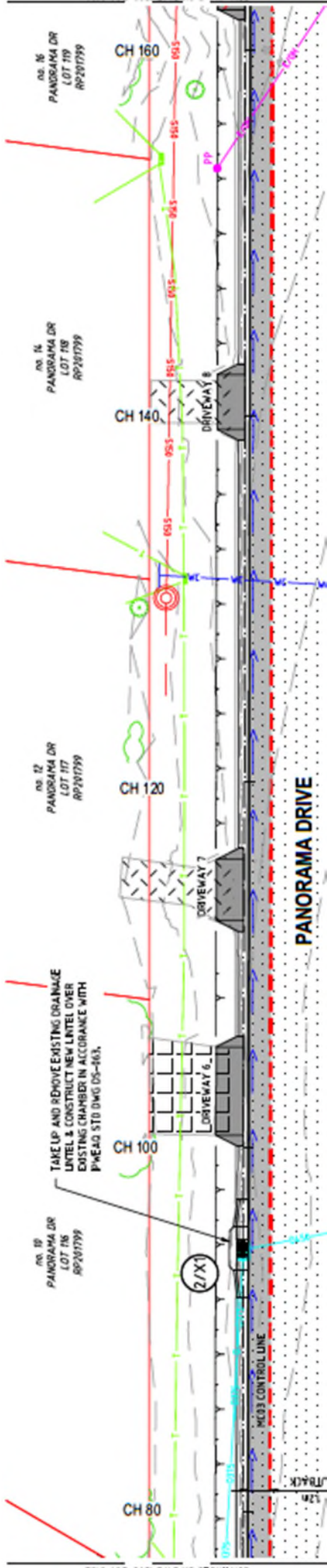

Kerb and Channel Replacement—Panorama Drive (Bryant Street to Vista Street)

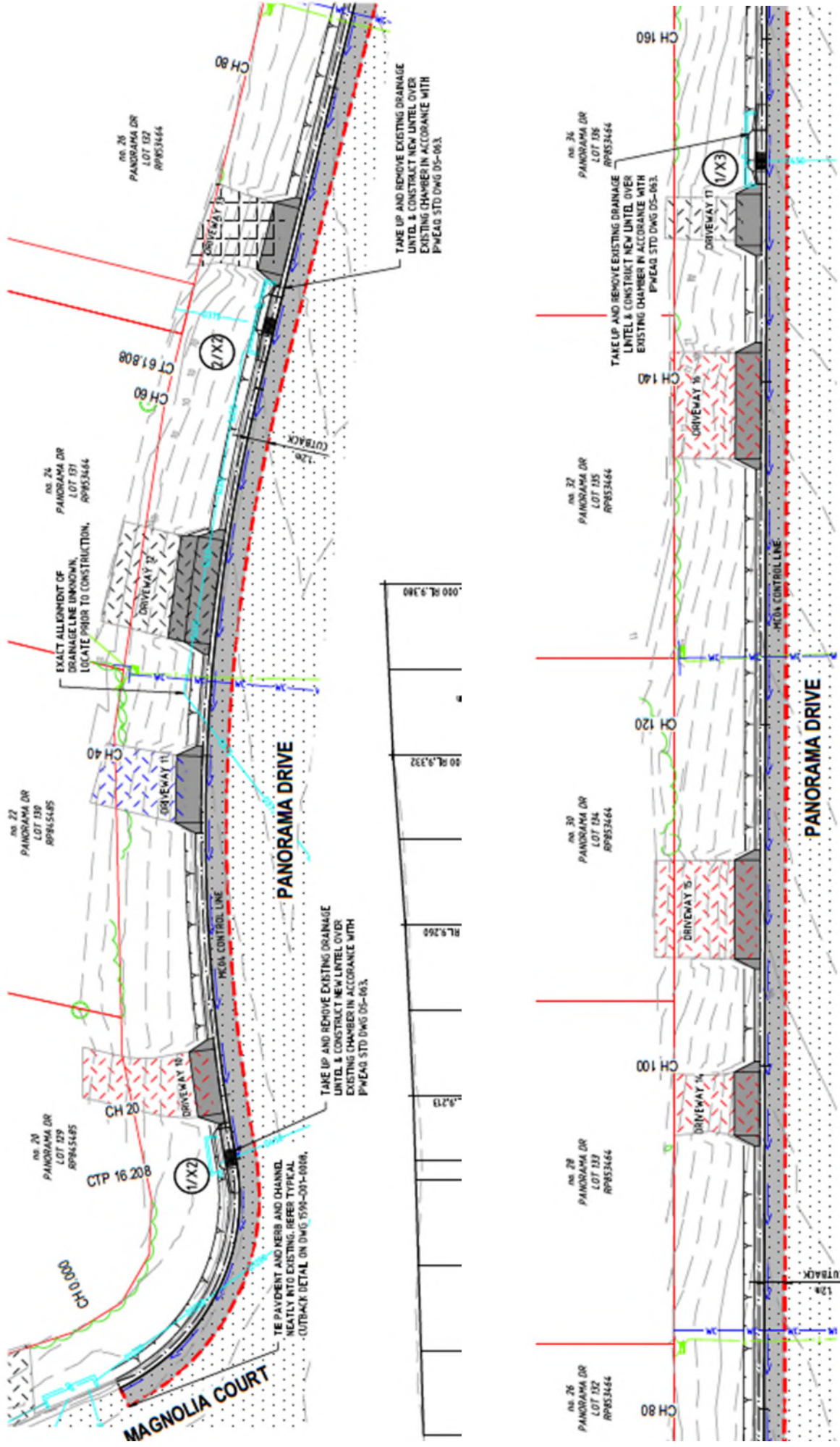



Kerb and Channel Replacement—Panorama Drive (Bryant Street to Vista Street)

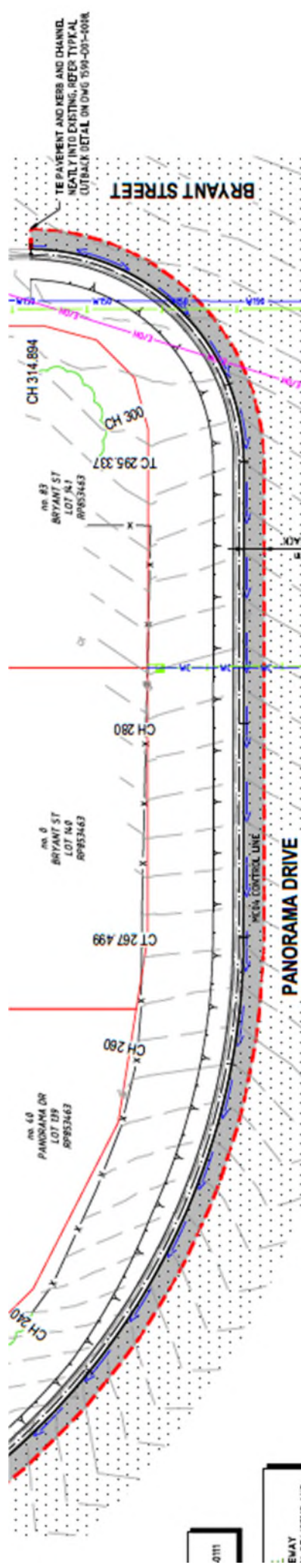
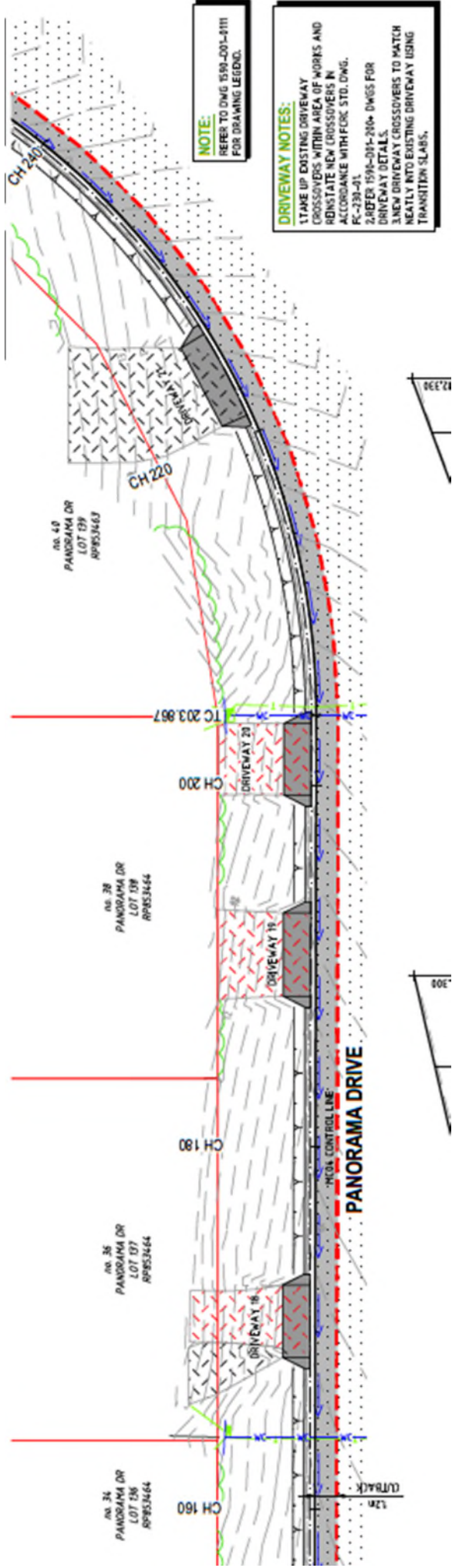

8111  
 EWAY

Kerb and Channel Replacement—Panorama Drive (Bryant Street to Vista Street)

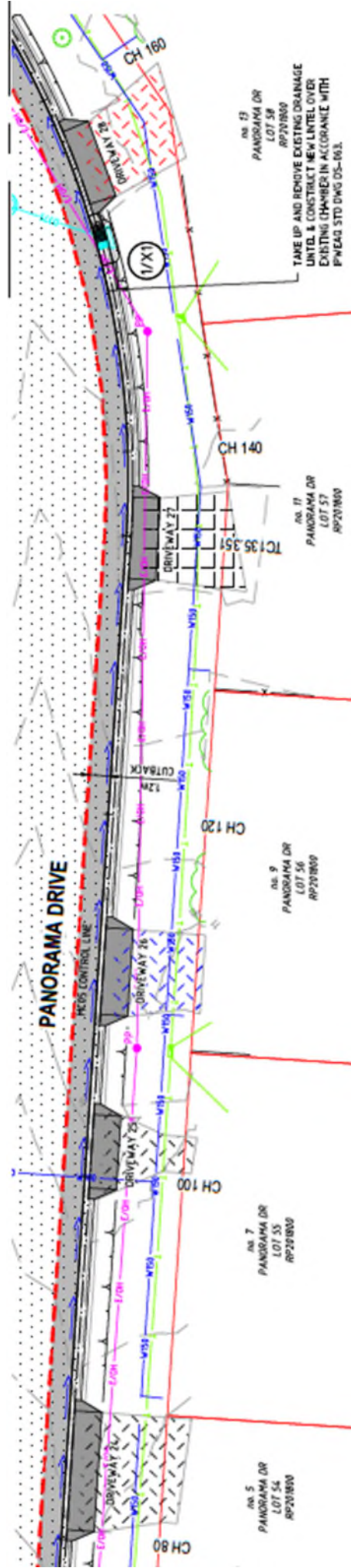
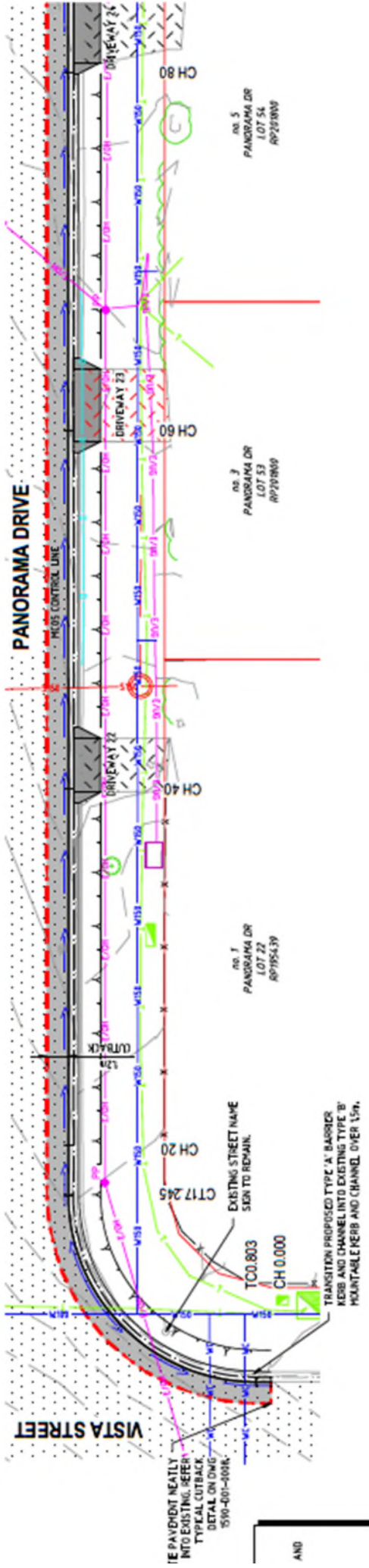



Kerb and Channel Replacement—Panorama Drive (Bryant Street to Vista Street)

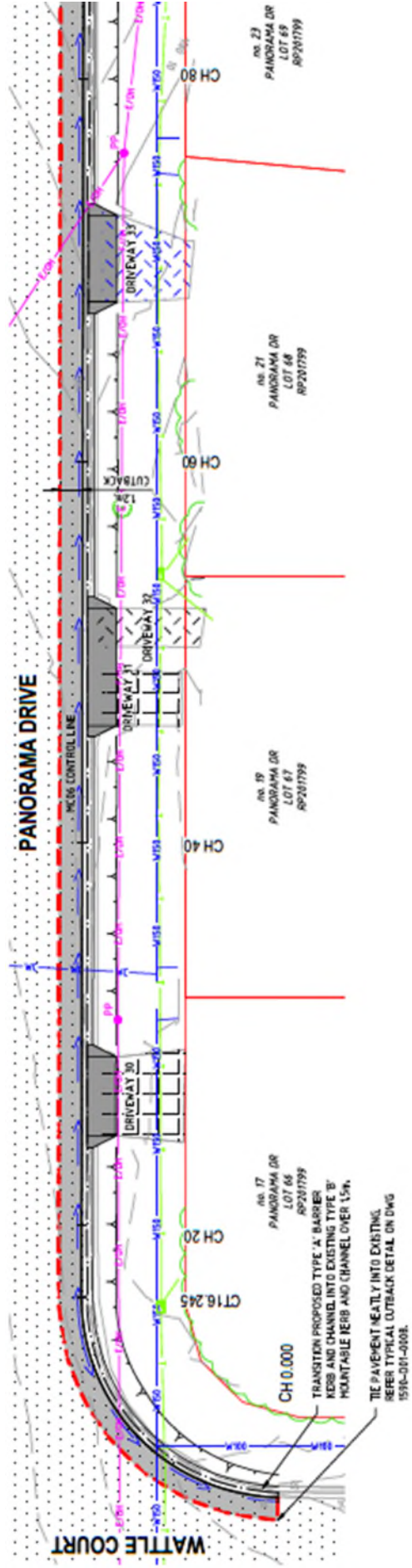
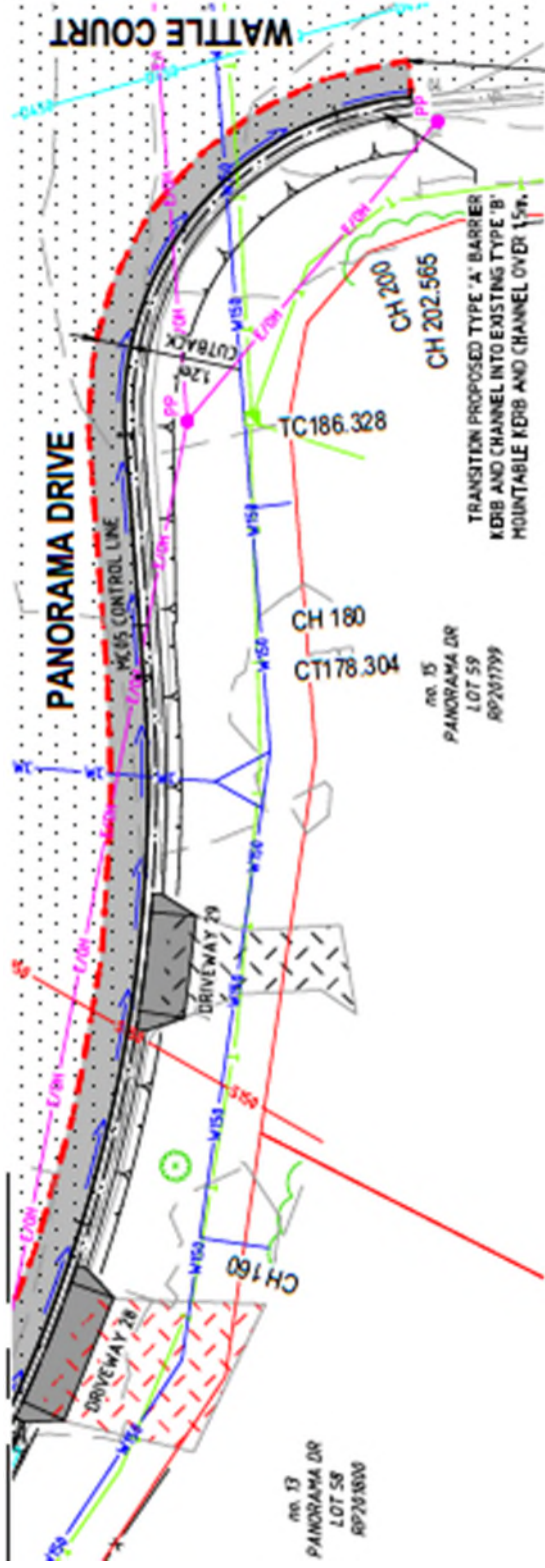

Kerb and Channel Replacement—Panorama Drive (Bryant Street to Vista Street)

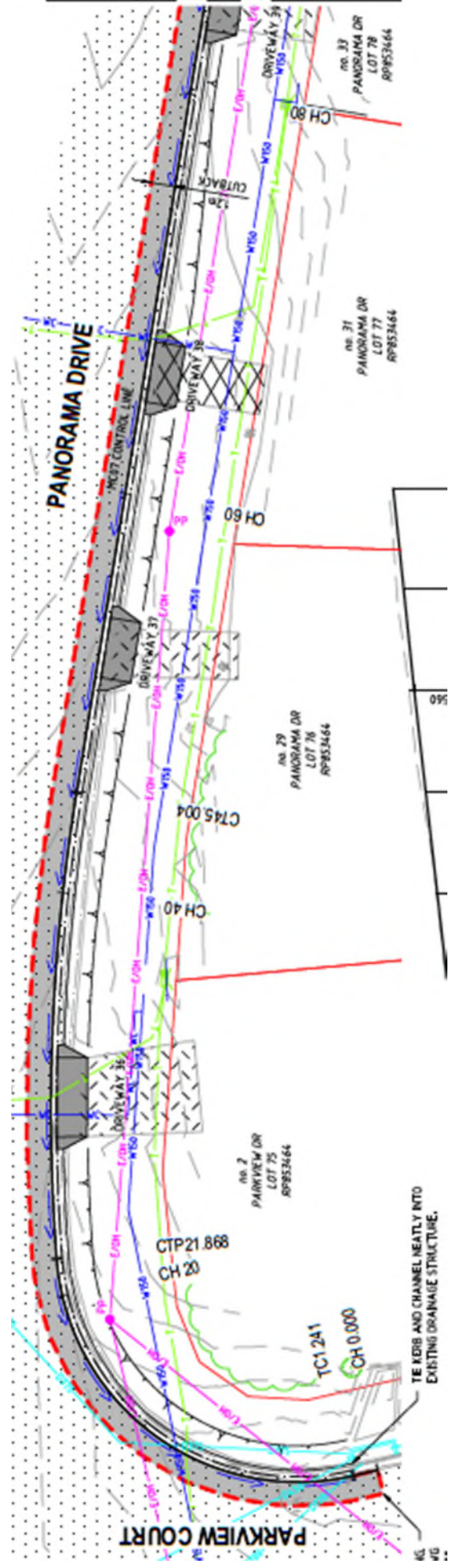
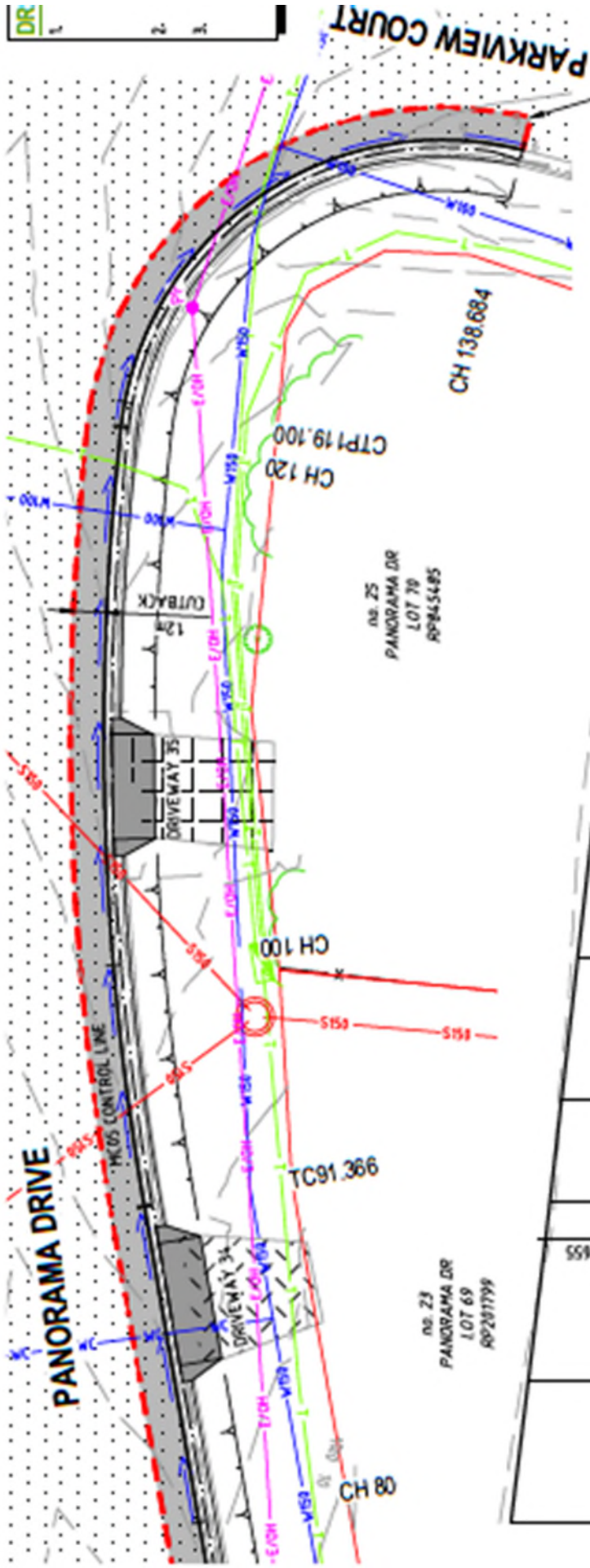

TE KERB AND CHANNEL NEATLY INTO EXISTING DRAINAGE STRUCTURE.



Kerb and Channel Replacement—Panorama Drive (Bryant Street to Vista Street)

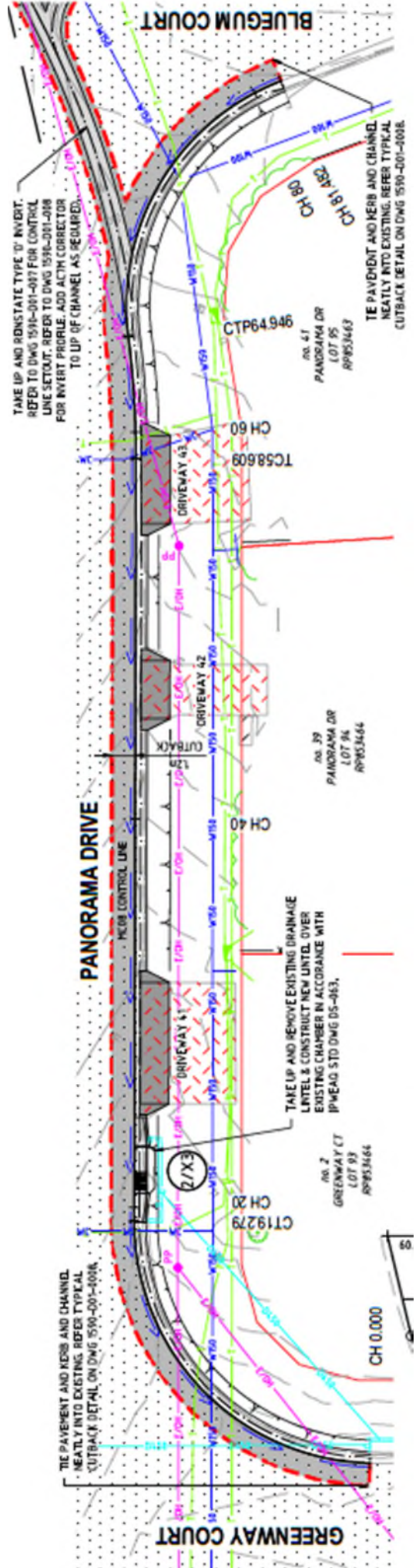
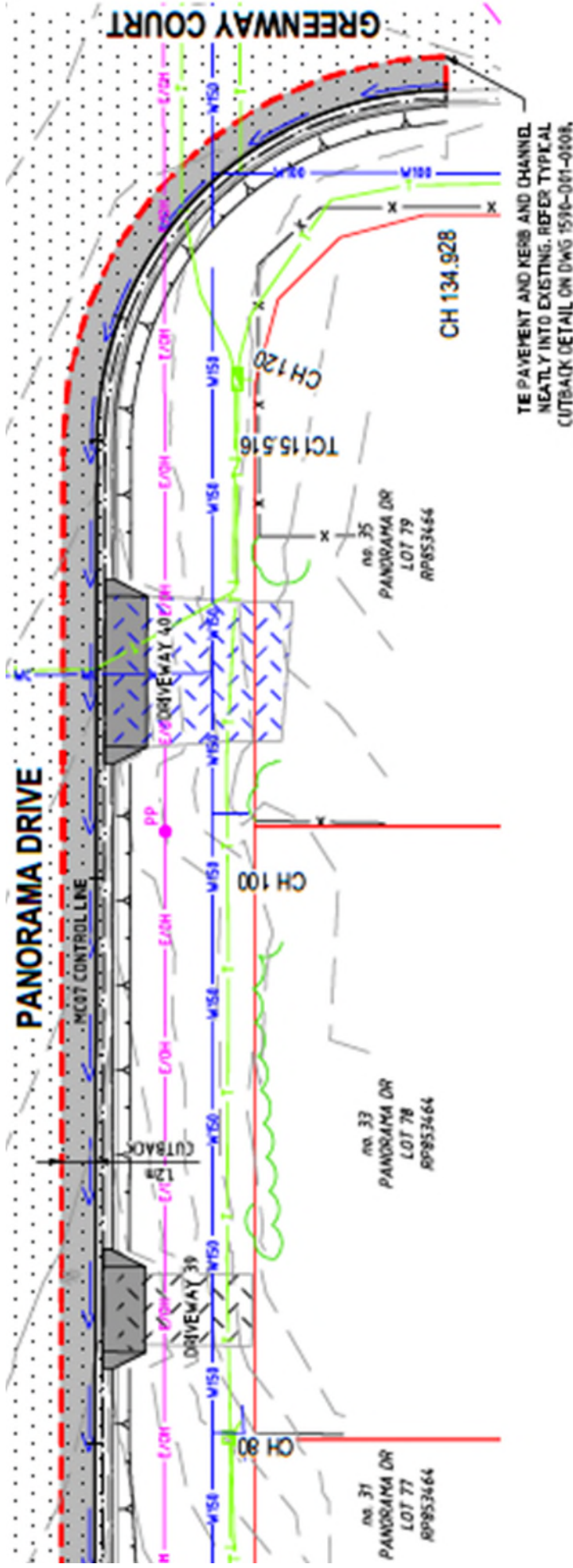



Kerb and Channel Replacement—Panorama Drive (Bryant Street to Vista Street)

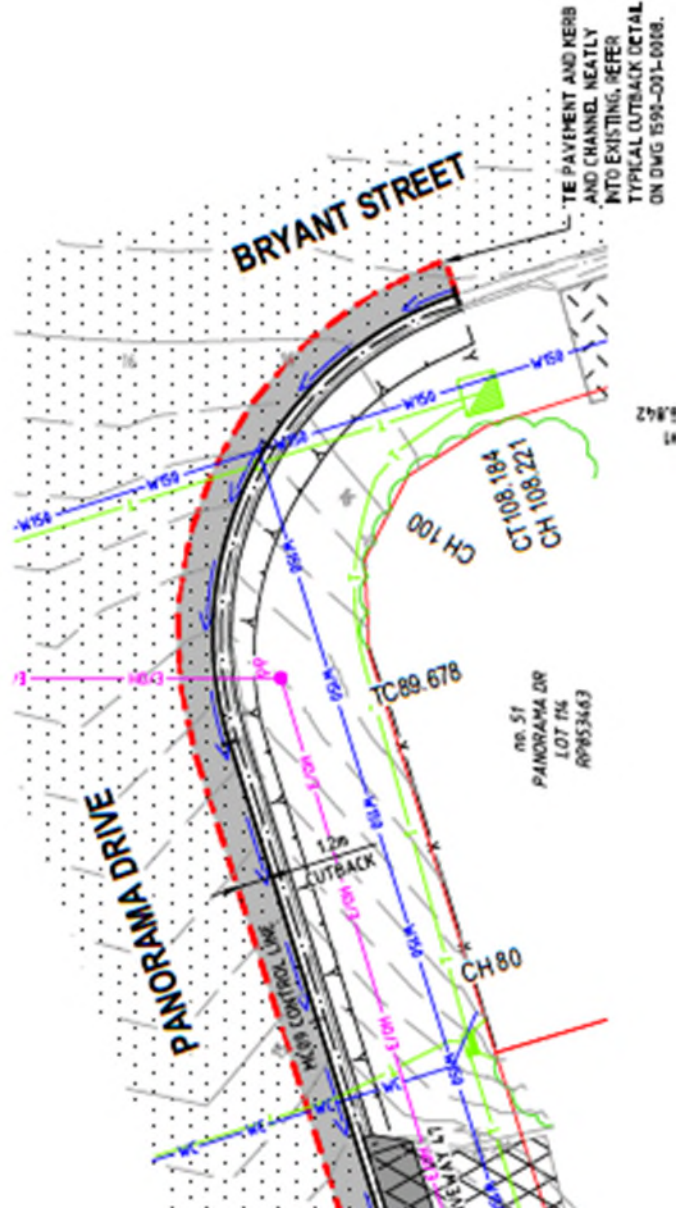
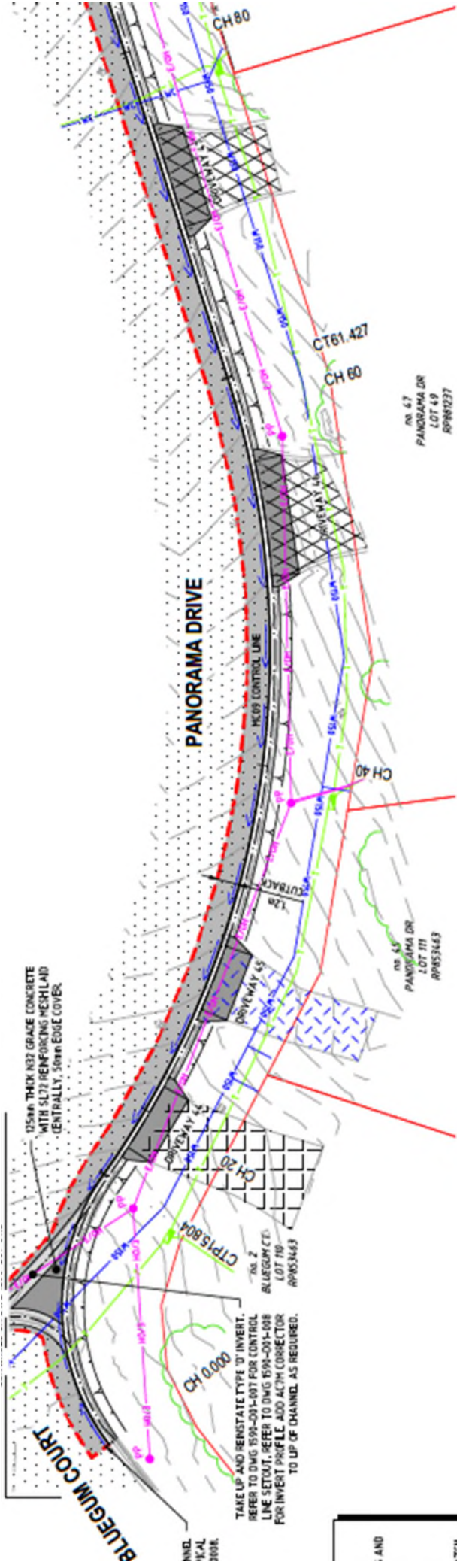

AND  
CIR